

# THE BARRETT FLOOR PLAN

LOWER LEVEL

ELEVATION A

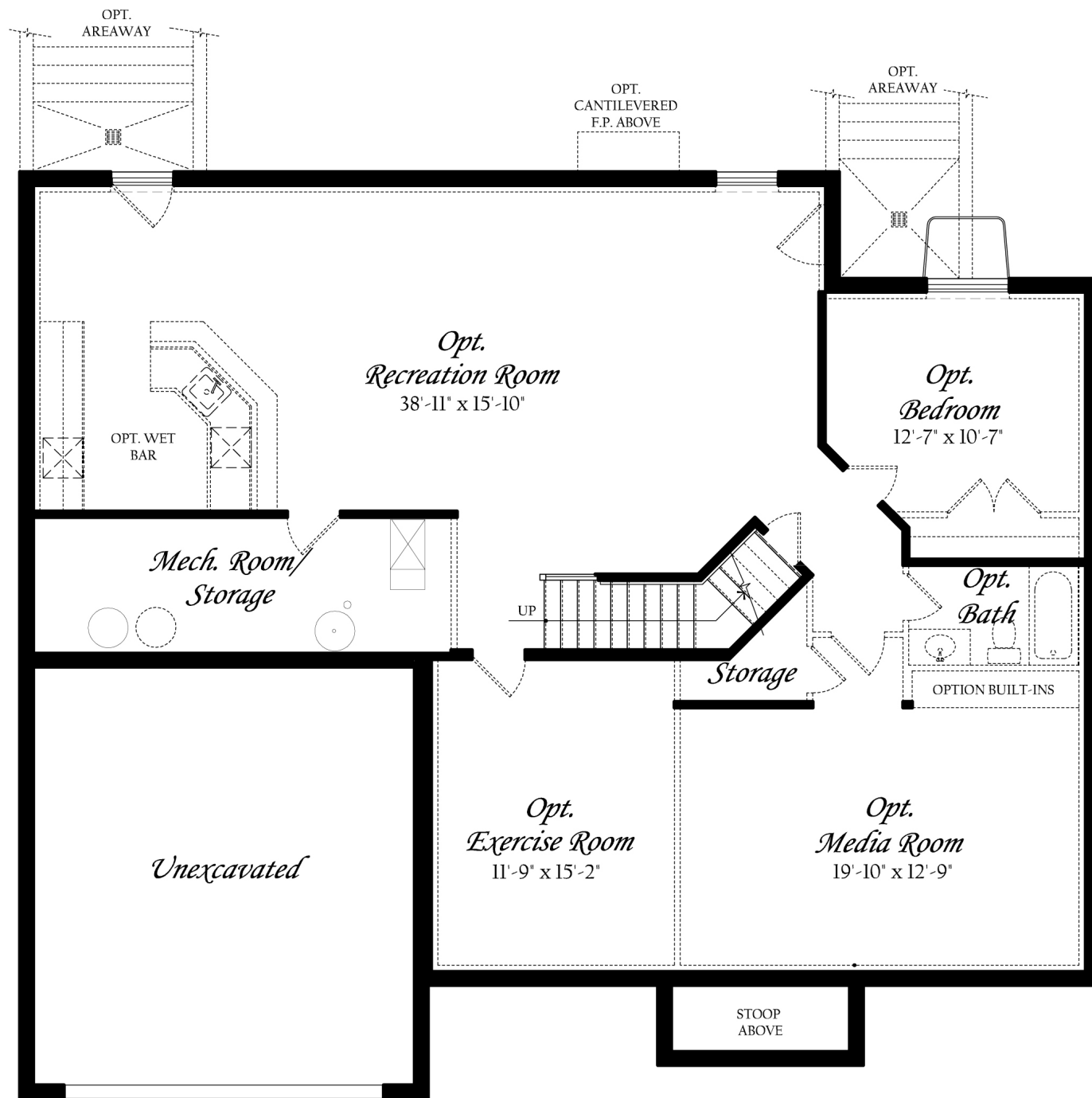

# THE BARRETT

## MINOR HILL

6501 36TH ST N ARLINGTON, VA 22213



PICTURED: ELEVATION K WITH OPTIONS

APPROXIMATELY 3,679 SF  
STANDARD WITH 4 BD, 3.5 BA

Evergreene  
HOMES





# Evergreene Homes Standard Features

## THE PLATINUM FINISH PACKAGE

### ATTENTION TO DETAIL

#### Distinctive Exteriors

- 2 x 6 Framed Exterior Walls with Poured Concrete Foundation
- M/I Brand Vinyl Windows Low E Glass with Contoured Grids
- CertainTeed Landmark 30 Year Architectural Shingles
- James Hardie 8.5" Color Plus Siding
- Masonite Fiberglass Entry Door w/ Schlage Handle & Lock
- Stone or Brick Front Water Table (Per Plan)
- Garage Door Opener w/ 2 Remote Controls & Keypad
- Finished Garage: Painted w/ Trim
- Custom Designer Maxim Brand Lighting Fixture Package
- Hose Bibs & GFI Outlets - Front & Rear
- Landscape Design Including Shrubs & Sod/Seed (Per Plan)
- Beautifully Appointed Exterior Features
- Flagstone or Brick Front Porch/Stoop & Stairs (Per Plan)

#### Elegant Interior Features

- Interior Floorplans Designed to Maximize Natural Light
- Ceiling Heights: Basement - 9', 1st Floor - 9', 2nd Floor - 9'
- Upgraded Gourmet Kitchen Layout
- Deluxe 42" (Upper) Cabinets & Hardware
- Moen Designer Kitchen Faucet
- Soft Close Doors and Drawers (Dovetail) Throughout
- Granite Kitchen Countertops w/ Choice of Double Bowl Sinks
- Ceramic Tile Backsplash in Kitchen
- #REF!
- Whirlpool S/S Appliances with Oven/Microwave Combo
- Classic Oak Stairs and Handrails From Main to Upper Level
- Shaw Hardwood Floors - Entire 1st Floor & 2nd Floor Hall
- Decorative Colonial Trim Package
- Coffered Ceilings: Family Room & Owners Bedroom
- Heatilator/Heat N Glo Fireplace w/ Slate Surround
- Home Wiring with 3 Internet, Cable, and Phone Connections
- McCormick Paints Brand: 3-Toned Interior Paint
- Abundant Recess Lighting (Per Plan)

#### Appointed Owner's Bath

- Granite Vanity Countertops - Owner's Bath
- Kohler Soaking Tub & Separate Shower (Per Plan)
- Ceramic 12 x 12 Tile Floors & 9 x 12 Walls in Full Baths
- Moen Quality Fixtures & Bath Hardware
- Sterling Elongated Toilets

#### Attention to Secondary Baths & Closets

- Pedestal Sink w/ Decorative Mirror in Powder Room
- Granite Vanity Countertops - Secondary Baths
- Ceramic 12 x 12 Tile Floors & 9 x 12 Walls in Full Baths
- Sterling Vikrell 5' Tub/Shower
- Moen Quality Fixtures & Bath Hardware
- Sterling Elongated Toilets
- Upgraded Wood Shelving in Closets and Kitchen Pantry

#### Energy Efficient Features

- HERS Rated Home (Including a Blower Door Test)
- Energy Star Appliances
- CFL Energy Efficient Bulbs (Per Plan)
- Rheem Brand Furnace, 92% Energy Efficient, 15 SEER A/C
- Honeywell Programmable Thermostat (1 Per Zone)
- Aprilaire Humidifier (Lower Zone)
- R-49 Attic Insulation, R-21 Exterior Wall Insulation
- Amarr Insulated Garage Door (Per Plan)
- Housewrap, Taping & Poly Seal Program
- 75 Gallon Quick Recovery "Power Vent" Water Heater (if Gas)
- 2 x 6 Framed Exterior Walls
- Passive Radon System
- Trion 5" Electrostatic Charged Media Air Filter (Lower Zone)

#### Warranty

- 1 Year Material & Workmanship / 2 Year Mech Warranty
- 10 Year Structural & Transferable Warranty - Issued by PWSC

Availability, selections and pricing are subject to change at any time without prior notice.



703.667.7878  
Sales@EvergreeneHomes.com  
MyEvergreeneHome.com

Updated: 3/13/17